

Chislehurst and St. Paul's Cray Commons

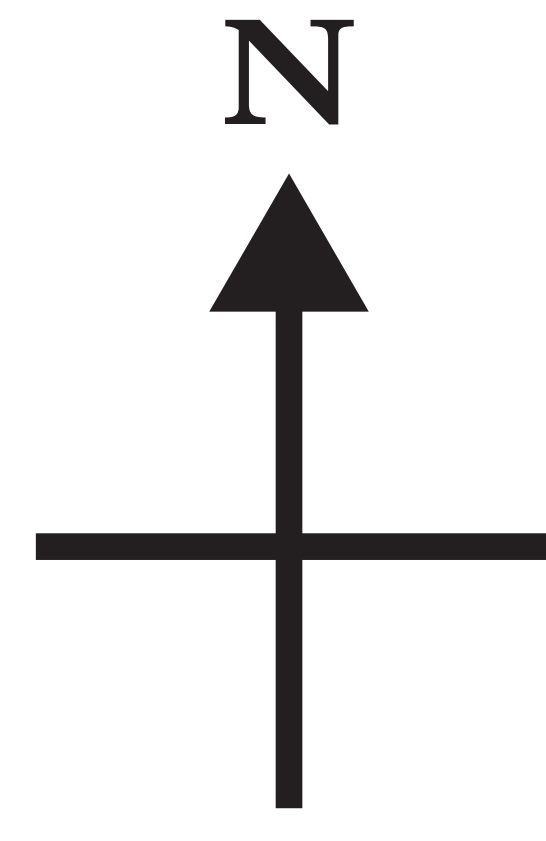
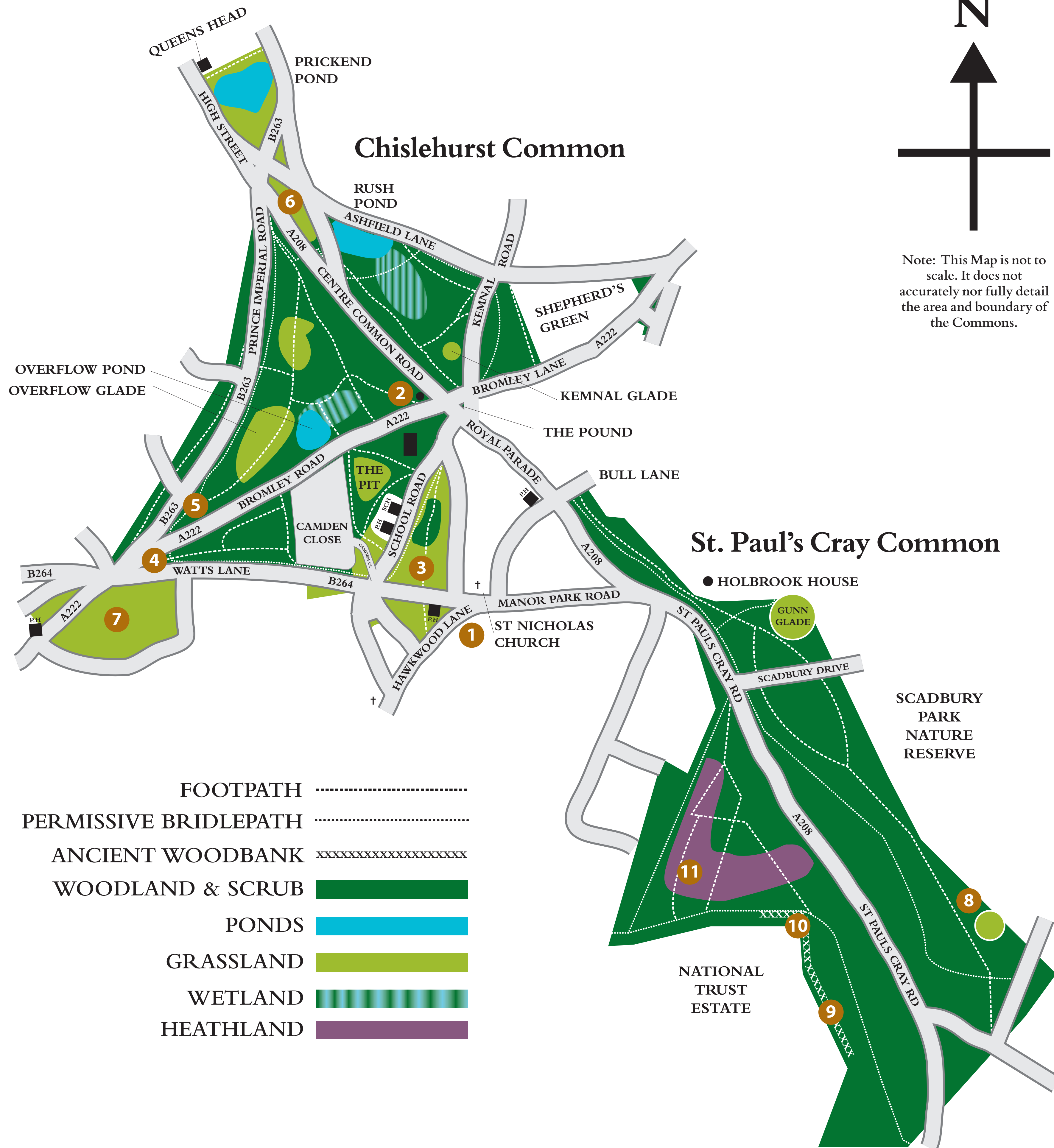

Note: This Map is not to scale. It does not accurately nor fully detail the area and boundary of the Commons.

PLACES OF INTEREST

1. **THE OLD FIRE STATION**, now the office of Chislehurst Commons.
2. **WAR MEMORIAL**, Erected after the First World War with donations from local people, and unveiled on October 20th 1920, it was designed by Sir Reginald Bloomfield, who also chose the site.
3. **THE COCKPIT**, which was used as a cock-fighting arena until the practice was outlawed in 1834.
4. **HANGMAN'S CORNER**, is the site on which a gibbet is thought to have stood.
5. **PRINCE IMPERIAL MONUMENT**, was erected by local subscription in 1880, commemorating Louis Napoleon, son of the exiled Emperor Napoleon III and Empress Eugenie, who lived at Camden Place, now the home of Chislehurst Golf Club.
6. **MAY QUEEN FIELD**, where the crowning of the May Queen has taken place on the first Saturday in May since 1923.
7. **THE CRICKET GROUND**, home to West Kent Cricket Club since 1822.
8. **DABNER'S GLADE**, A weather-boarded Kentish cottage, first a smithy, then a bakery, stood here until it was burnt down in 1937. The footpath follows the line of the old road to St. Mary Cray.
9. **THE WOODBANK**, with its line of pollarded oaks and parallel ditch, now marks the boundary between the Common and the adjacent National Trust land.
10. **THE WILLIAM WILLETT SUNDIAL (ON NT LAND)**, commemorates the local man who promoted the idea of British Summer Time.
11. **RESTORED HEATHLAND**, showing the appearance of much of the Commons until grazing stopped a century ago.



Registered Charity No. 1028121